

The background of the slide is a green-tinted aerial photograph of a suburban area. It shows a grid of streets, numerous houses, and several large, irregularly shaped open spaces or parks. A prominent road or railway line runs diagonally across the middle of the image. The overall texture is that of a high-resolution aerial map.

Edward Foord Bromley's disappearing New Town

Dr Imogen Wegman
School of Humanities and Social Sciences
Imogen.Wegman@utas.edu.au

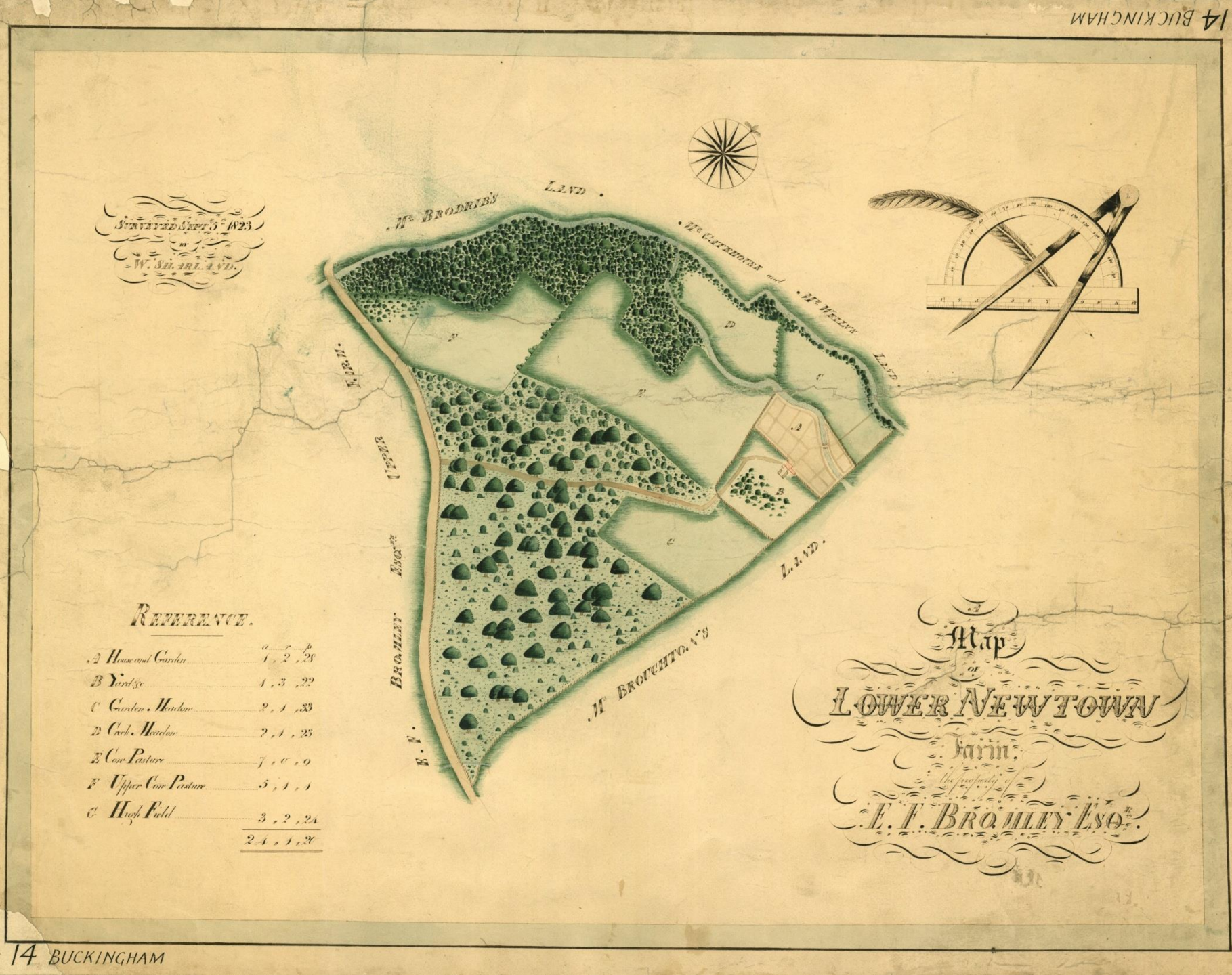



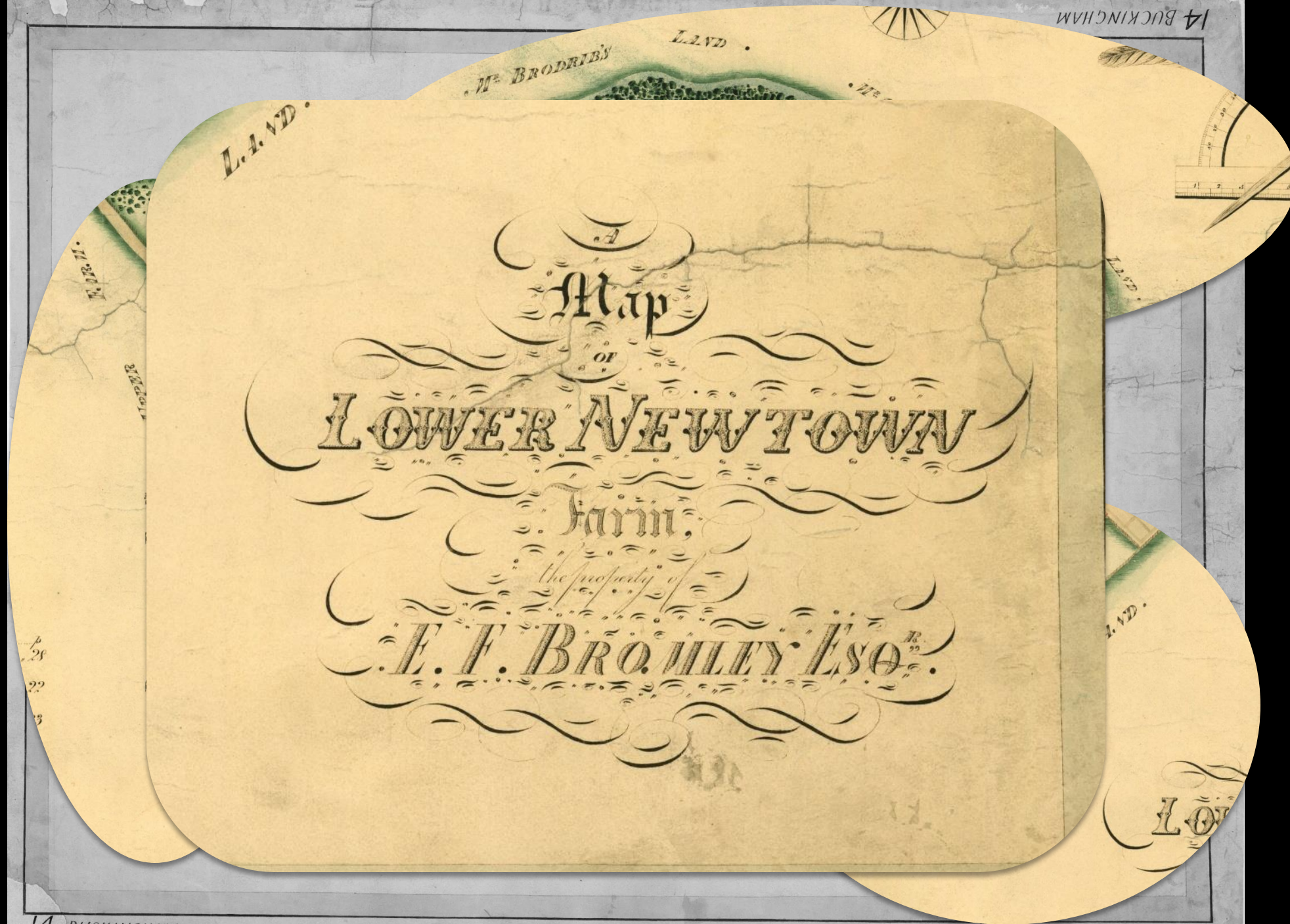

L.A. & D.

REFERENCE.

A House and Garden	a . r . p
B Yard &c	1 . 2 . 28
C Garden . Meadow	1 . 3 . 22
D Creek . Meadow	2 . 1 . 33
E Cow Pasture	2 . 1 . 23
F Upper Cow Pasture	7 . 0 . 9
G High Field	5 . 1 . 1
	3 . 2 . 24
	<hr/> 24 . 1 . 20 <hr/>

A
Map
OF
NEW TOWN
Farm,
Property of
RO. MLEY ESQ.
R.
W.
W.

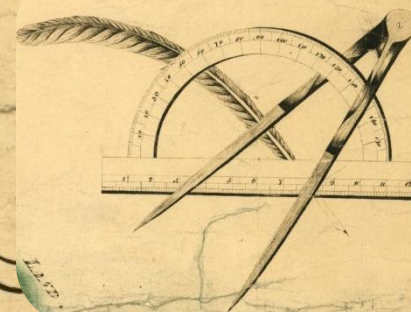

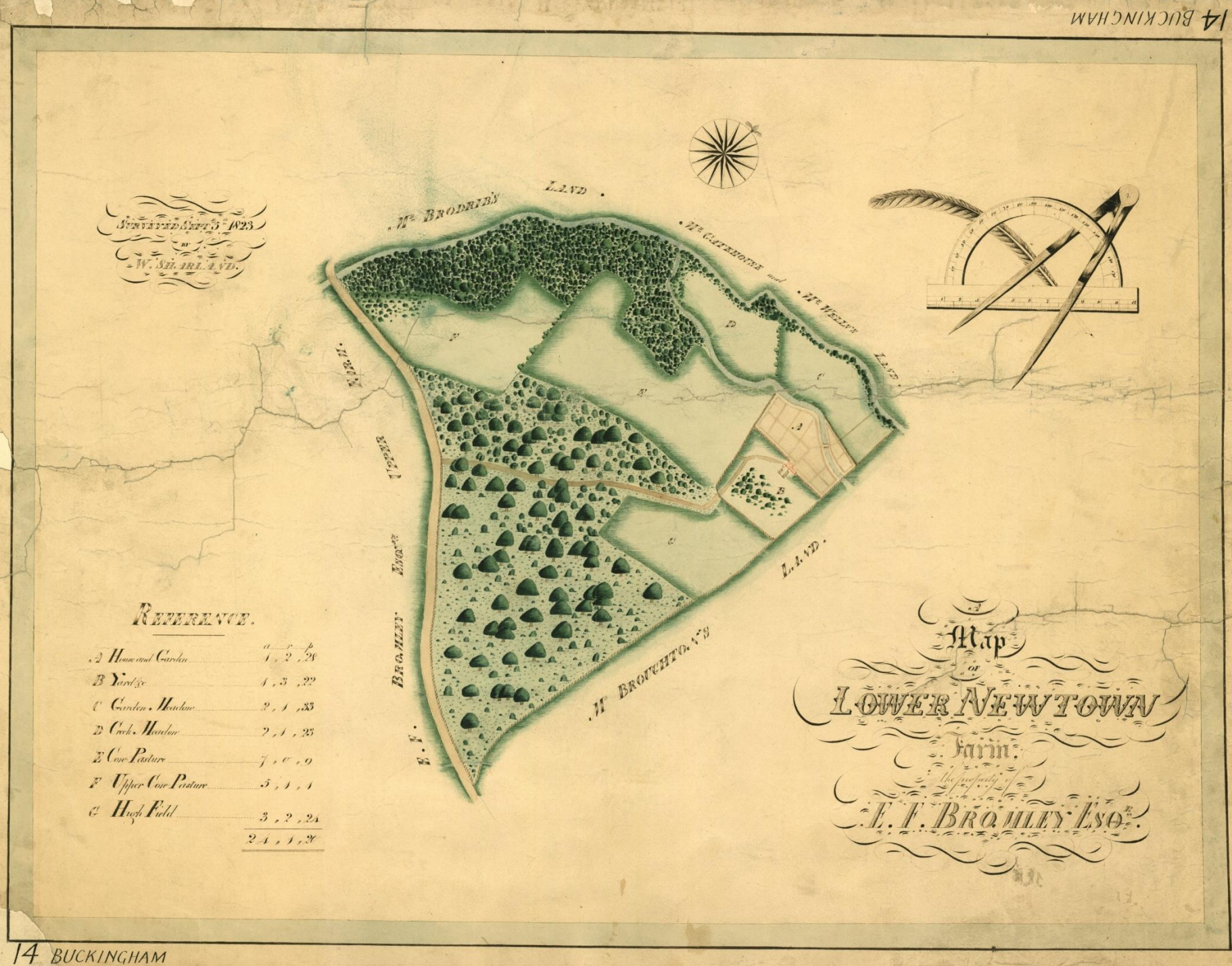



GARDEN PRODUCE.—In the garden at the farm of E. F. BROMLEY, Esq. near New-town, from a very fine plot of onions, several have been lately dug, weighing one pound each.—In the D. Judge Advocate's garden in Hobart Town, the potatoes from one root weighed eight pounds; two of them weighed one pound and a half each.—It should however be observed that the seed potato was planted whole.

RASPBERRY WINE.—The cultiva-

Every dog
by the reg
person or p
the purpose
prevent the
effect is lia
of 100 doll

Improver

—M. Gona
brought th
to such ex
plate be gi
sions from



..... 500 ditto.
..... 500 ditto.
le ... 500 ditto.
WN.

required Weekly
per lb.

y required Weekly
per lb.

MOODIE, A. C. G.

e, May 12th, 1825.

ous of furnishing
is Majesty's Stores
encing 25th June
nit their Tenders to
nd at Launceston,

6th Day of that
ffers will be accept-

, Notice is hereby
ill be given to those

roportionate Quan-
MOODIE, A. C. G.

tely arrived from
ermined to fix his

own, purposes to
anches of Account-

ee in Commercial
at a knowledge of

ess, acquired dur-
re than 50 years,

some of the prin-
ualifies him for a
arious Duties he is

The King v. Bromley.

By Mr. R. W. Fruecht, at his Rooms in Ho-
bart Town, on Tuesday the 31st Instant, at
12 o'Clock, in Lots.

LOT 1.—A Capital Farm of 30 Acres, with
a small House and large Garden, well
stocked with choice Fruit Trees, &c.; delight-
fully situated about 2½ Miles from Hobart
Town.—The whole fenced in, and two Pad-
docks laid down in English Grasses.

Lot 2.—Is 103 Acres of Land, adjoining the
above, 10 Acres are fenced in, together with a
capital Barn, Kitchen, Store-room, a three-
stall Stable, and a large Barn-yard, well
fenced in about 68 yards square.

Lot 3.—A Farm of 100 Acres, situate about
2½ Miles from Hobart Town, bounded on the
one side by the New-town Rivulet, a small
part having been cleared for the purpose of
making hop-grounds.

Lot 4.—A Farm of 100 Acres, adjoining the
above, about 60 Acres enclosed, a small part
of the Farm laid down with English Grasses;
and a beautiful Garden neatly laid out. These
Farms are situated at New-town, and well
worth the attention of new Settlers.

Lot 5.—Is a weather-boarded House and
Premises, situated in Harrington-street, Ho-
bart Town.

Unless the several Executions thereon be
previously superseded.

DUDLEY PEREDAY, Sheriff.

MR. DONALDSON, late from London, most

M in Campbell
Rum, real Holland
Rum Shrub, Rice
Cottons, a great va
Colouring, Gunpow
dispose of either w
most reasonable Te

MR. BUNSTER ha
M of London Bo
penior Madeira Win
seed Oil, Hams, W
Gentlemen's Wearin
few Bales of Slops.

MR. B. GUY, of
M to his great su
ment in the last W
is stated that Appl
" B. Guy, Esq. Gou
to inform the Pub
ment can have no r
not caused any Adv
be inserted, nor is
mation on the Subje

CEDAR.—Messrs
C beg leave to ad
the Public, that the
tity of Cedar, per
good quality; whic
moderate Terms, an
required.

Elizabeth-street,

FOR SALE by P
dred and Twe



“The greater part of [the inhabitants of Hobart] either are or have been convicts: and house-breaking is not uncommon. . . . It is but natural for the good people of Hobart-town to keep up their old practice of paying their visits in the night time. . . . Hobart-town certainly flags the spirits a little at first.”



“Our digestive powers rival or exceed those of the ostrich. . . . A life of indolent ease cannot be led here: it must be one of stirring activity.”



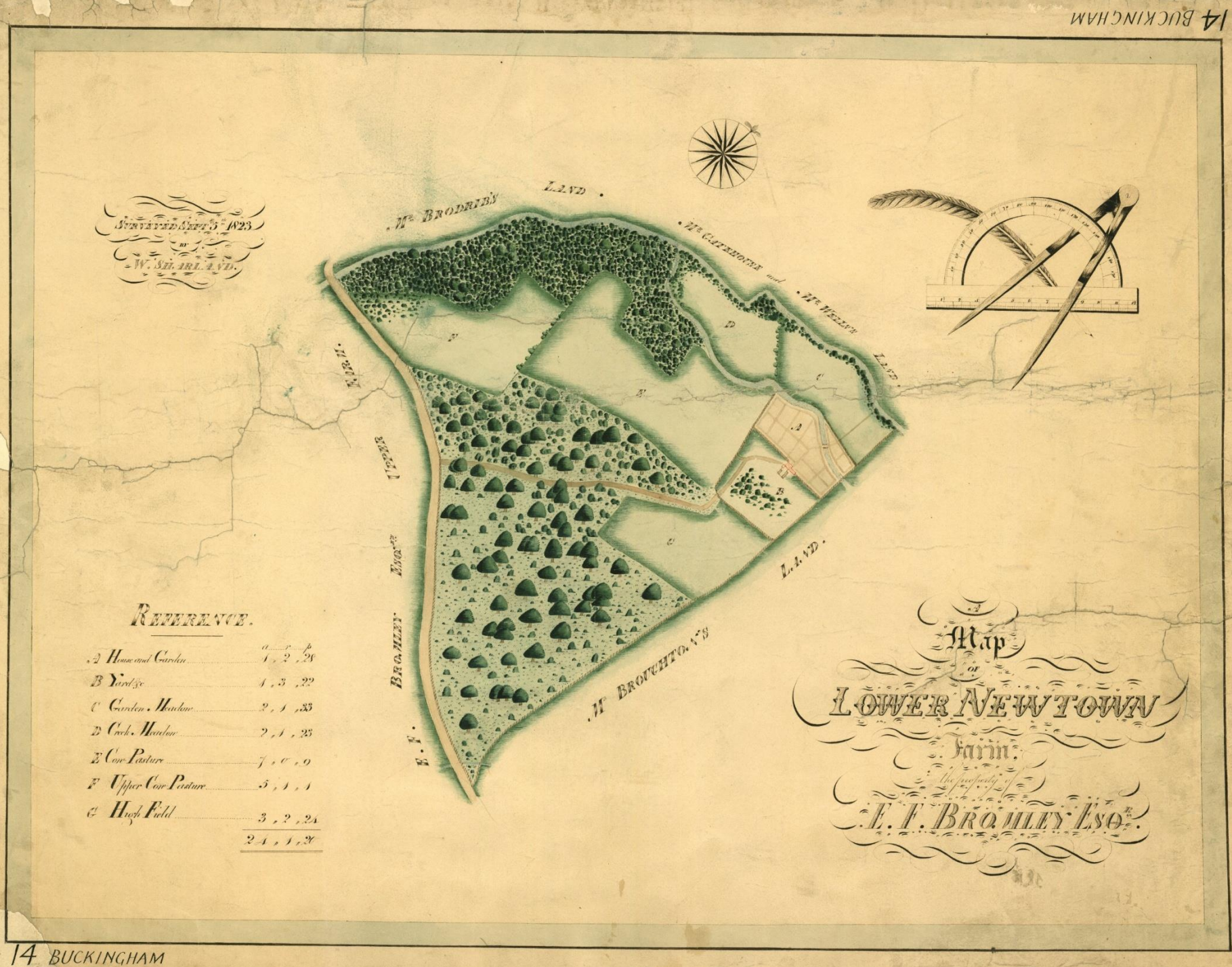

CAUTION.—In Consequence of the numerous Persons who still continue trespassing upon the Lands of E. F. BROWLEY, Esq. by cutting down and carrying away (in Carts) Timber therefrom; Notice is hereby given, that there is now proper Persons placed on the same Farms who have received positive Directions to inform the Proprietor of all Persons who may in future be found so trespassing on either of the said Grounds, so that they may be sued for all Damage accruing from all such Trespass.—All Persons therefore, whom this may concern, are requested to observe, that this Notice is not a mere formal one, but that it will be enforced with the utmost Rigour of the Law.

For general Information the said Farms are here-under particularized; that is to say;—

The Estate on the left side of the High Road from Hobart Town, known by the Name of Stanley's Farm.

The Estate on the said side of the Road, about $1\frac{1}{2}$ Miles from Town, and called Mitchell's Farm.

The Estate adjoining Mitchell's Farm, known by the Name of Sponsford's Farm.

The Estate bounded by Mr. Luttrell's Farm at New Town, known by the Name of Hayes's Farm.

The Estate adjoining Hayes's Farm, known by the Name of Nicholl's Farm.

N. B.—As the Boundaries of all these Farms are publicly known, no trespass whatsoever can hereafter be overlooked.



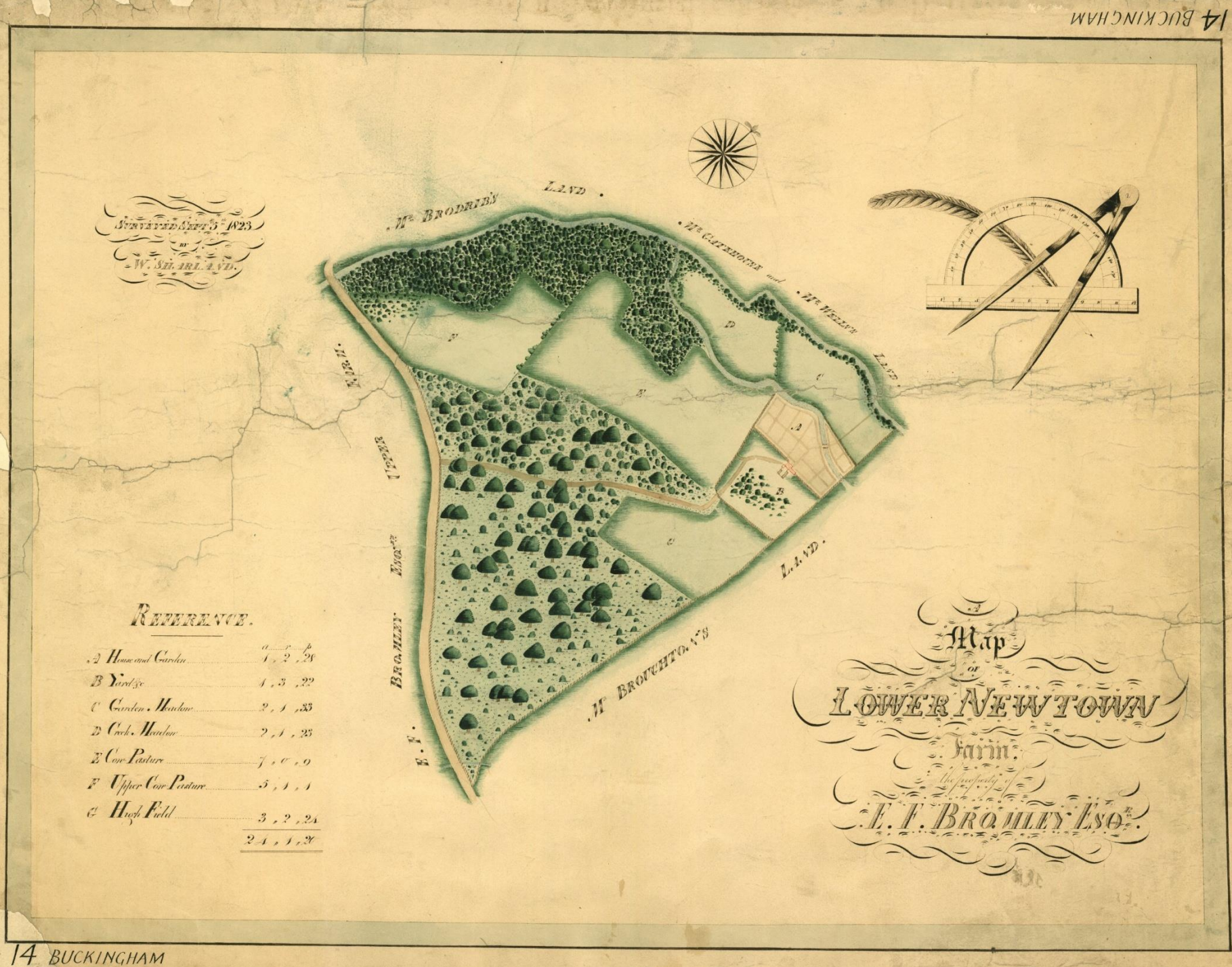



..... 500 ditto.
..... 500 ditto.
le ... 500 ditto.
WN.

required Weekly
per lb.

y required Weekly
per lb.

MOODIE, A. C. G.

e, May 12th, 1825.

ous of furnishing
is Majesty's Stores
encing 25th June
nit their Tenders to
nd at Launceston,

6th Day of that
ffers will be accept-

, Notice is hereby
ill be given to those

roportionate Quan-
MOODIE, A. C. G.

tely arrived from
ermined to fix his

own, purposes to
anches of Account-

ee in Commercial
at a knowledge of

ess, acquired dur-
re than 50 years,

some of the prin-
ualifies him for a
arious Duties he is

The King v. Bromley.

By Mr. R. W. Fruecht, at his Rooms in Ho-
bart Town, on Tuesday the 31st Instant, at
12 o'Clock, in Lots.

LOT 1.—A Capital Farm of 30 Acres, with
a small House and large Garden, well
stocked with choice Fruit Trees, &c.; delight-
fully situated about 2½ Miles from Hobart
Town.—The whole fenced in, and two Pad-
docks laid down in English Grasses.

Lot 2.—Is 103 Acres of Land, adjoining the
above, 10 Acres are fenced in, together with a
capital Barn, kitchen, Store-room, a three-
stall Stable, and a large Barn-yard, well
fenced in about 68 yards square.

Lot 3.—A Farm of 100 Acres, situate about
2½ Miles from Hobart Town, bounded on the
one side by the New-town Rivulet, a small
part having been cleared for the purpose of
making hop-grounds.

Lot 4.—A Farm of 100 Acres, adjoining the
above, about 60 Acres enclosed, a small part
of the Farm laid down with English Grasses;
and a beautiful Garden neatly laid out. These
Farms are situated at New-town, and well
worth the attention of new Settlers.

Lot 5.—Is a weather-boarded House and
Premises, situated in Harrington-street, Ho-
bart Town.

Unless the several Executions thereon be
previously superseded.

DUDLEY PEREDAY, Sheriff.

MR. DONALDSON, late from London, most

M in Campbell
Rum, real Holland
Rum Shrub, Rice
Cottons, a great va
Colouring, Gunpow
dispose of either w
most reasonable Te

MR. BUNSTER ha
M of London Bo
penior Madeira Win
seed Oil, Hams, W
Gentlemen's Wearin
few Bales of Slops.

MR. B. GUY, of
M to his great su
ment in the last W
is stated that Appl
" B. Guy, Esq. Gou
to inform the Pub
ment can have no r
not caused any Adv
be inserted, nor is
mation on the Subje

CEDAR.—Messrs
C beg leave to ad
the Public, that the
tity of Cedar, per
good quality; whic
moderate Terms, a
required.

Elizabeth-street,

FOR SALE by P
dred and Twe



“Few practical farmers have ever emigrated to the colony. The earlier settlers were chiefly artizans, of intemperate habits, unacquainted with husbandry, and disinclined to attain a knowledge of it. Still, they obtained and located themselves on grants of land; turned up the soil, and threw grain into it; and it being grateful, repaid their rude essays with bountiful harvests. This was sufficient. When one piece of land was exhausted, another was broken up.”



